

2007-2008 1604 Campus Parking Map
Effective August 1, 2007

*UNO Parking
 (Unmarked spots on roof)*

*UNO exam
 HSS 2.01.10
 Sat 29 Sep
 9 AM
 (arrive
 15' early)*

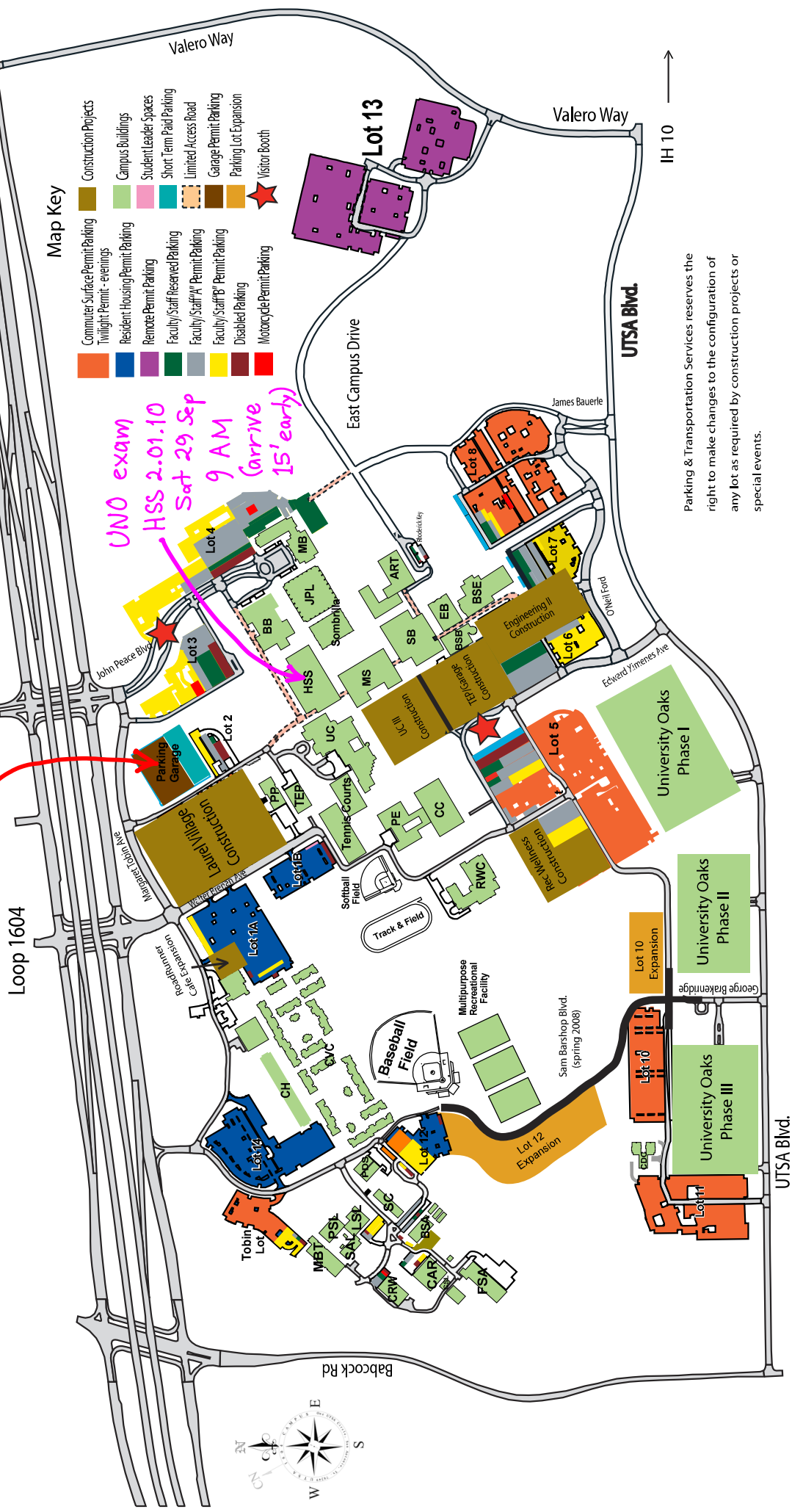

Map Key

- | | | | |
|--|----------------------------------|--|-------------------------|
| | Commuter Surface Permit Parking | | Construction Projects |
| | Twilight Permit - evenings | | Campus Buildings |
| | Resident Housing Permit Parking | | Student Leader Spaces |
| | Remote Permit Parking | | Short Term Paid Parking |
| | Faculty/Staff Reserved Parking | | Limited Access Road |
| | Faculty/Staff 'A' Permit Parking | | Garage Permit Parking |
| | Faculty/Staff 'B' Permit Parking | | Parking Lot Expansion |
| | Disabled Parking | | Visitor Booth |
| | Motorcycle Permit Parking | | |

Parking & Transportation Services reserves the right to make changes to the configuration of any lot as required by construction projects or special events.

Building Key

- | | | | |
|-----|---------------------------------------|-----|-------------------------------------|
| ART | ART BUILDING | PSL | PHYSICAL SCIENCE LABORATORY |
| BSB | BIO SCIENCES BUILDING | PDS | POWER & DYNAMICS SYSTEMS LABORATORY |
| BSE | BIO TECHNOLOGY SCIENCES & ENGINEERING | RWC | RECREATION WELLNESS CENTER |
| BB | BUSINESS BUILDING | SB | SCIENCE BUILDING |
| BSA | BUSINESS SERVICE ANNEX | SC | SCULPTURE/CERAMICS |
| CAR | CAR CENTER FOR ARCHAEOLOGY RESEARCH | SAL | SMALL ANIMAL LABORATORY |
| CH | CHISOLM HALL | HSS | SOCIAL SCIENCES |
| CRW | CENTRAL RECEIVING & WAREHOUSE | TEP | THERMAL ENERGY PLANT |
| CVC | CHAPARRAL VILLAGE COMPLEX | UC | UNIVERSITY CENTER |
| CDC | CHILDCARE CENTER | UO | UNIVERSITY OAKS APARTMENTS |
| CC | CONVOCATION CENTER | | |
| EB | ENGINEERING BUILDING | | |
| FSA | FACILITIES SERVICES ANNEX | | |
| JPL | JOHN PEACE LIBRARY | | |
| LSL | LIFESCIENCE LABORATORY | | |
| MB | MAIN BUILDING | | |
| MBT | MARGARET BATTS TOBIN LABORATORY BLDG | | |
| MS | MULTIDISCIPLINARY STUDIES BUILDING | | |
| PE | PHYSICAL EDUCATION BUILDING | | |
| PP | PHYSICAL PLANT | | |

